



3 Thatch Cottages Fifield Bavant, Broad Chalke, Salisbury, Wiltshire, SP5 5HT

£1,100 PCM

A quintessential thatched country cottage in the Chalke Valley with 3 bedrooms and stunning views, long term tenancy

A charming 3 bed end terrace thatched cottage within the pretty hamlet of Fifield Bavant near Broadchalke approx 10 miles south west of Salisbury. The accommodation comprises: Kitchen with oil fired Rayburn, inset sink and drainer, shaker style units, inset electric hob with extractor over, built in electric oven, breakfast bar, window to front with pleasant view of surrounding farmland, rear hall leading to, ground floor bathroom with bath, mixer tap shower attachment, WC basin, window to rear, sitting-room with working inglenook fireplace, two windows to front with pleasant view to surrounding farm land. Stairs to landing with access to bedrooms. 2 double bedroom and 1 single, all with windows to front with pleasant view to surrounding farmland. Electric heating. Neutral carpets & decor. Large sloping garden, mainly laid to lawn. Brick outhouse for logs etc. UNFURNISHED. WATER & SEWAGE payable to FARM. Tenants need to be of a rural inclination/sympathetic to farming operations



Ground Floor

Approx. 45.7 sq. metres (491.8 sq. feet)

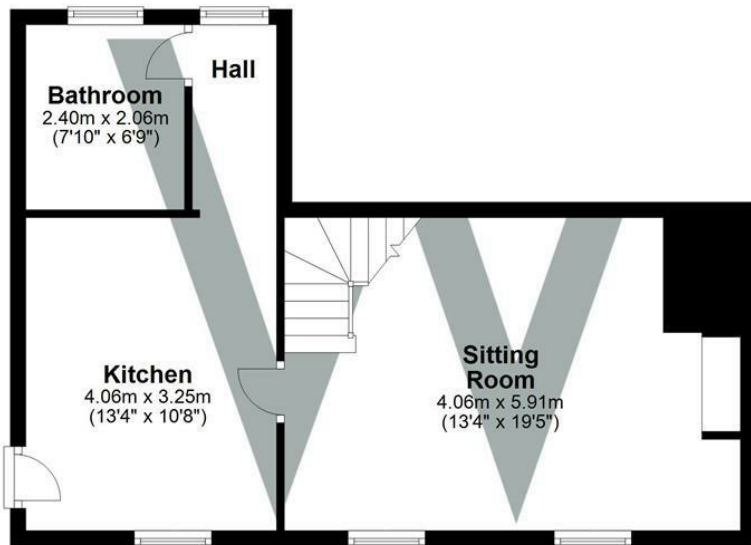

First Floor

Approx. 37.6 sq. metres (404.4 sq. feet)

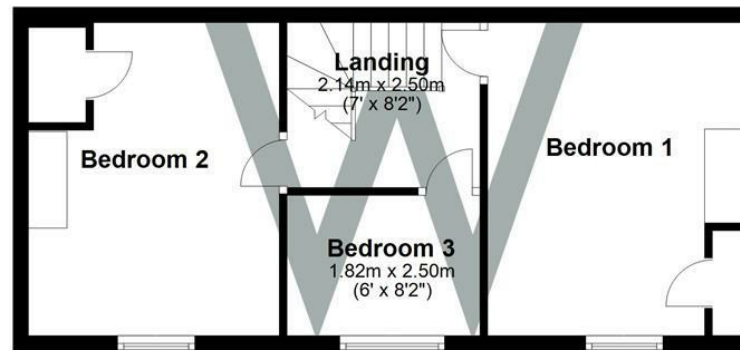

Total area: approx. 83.3 sq. metres (896.3 sq. feet)

Energy Efficiency Rating		Current	Potential
Very energy efficient - lower running costs			
(92 plus) A			
(81-91) B			
(69-80) C			
(55-68) D			
(39-54) E			
(21-38) F			
(1-20) G			
Not energy efficient - higher running costs			
		52	74
England & Wales		EU Directive 2002/91/EC	

WHITES
 Castle Chambers, 47 Castle Street,
 Salisbury, Wiltshire, SP1 3SP
 01722 336422
www.hwwhite.co.uk
residential-sales@hwwhite.co.uk

